



- 1 Castellarnau House
- 2 El Pallol Vault
- 3 Walls (Archaeological Promenade)
- 4 Canals House
- 5 Roman Circus-Praetorium
- 6 Amphitheatre
- 7 Colonial Forum
- 8 Mèdol Quarry
- 9 Les Ferreres Aqueduct

ENG

Castellarnau House



MIHIT
MUSEU
D'HISTÒRIA
DE TARRAGONA

TARRAGONA
ES CONNECTA
AMB LA CULTURA

Tarragona 2016
Comissió de Cultura i de
Espais Històrics de la Ciutat



PROPERTY OF CULTURAL INTEREST



Castellarnau House

The Castellarnau House was built at the start of the XV century. From then on, and up to the end of the XIX century, it was the residence of some of the most influential families in the city. Emperor Charles I lived here during his stay in Tarragona in 1542. Charles of Castellarnau bought it half-way through the XVIII century and it stayed in the family until, in 1954, it became municipal property.

The interior of the house still has architectonic structures from various periods. On the ground floor we can see a series of pointed arcs dated from the XIV and XV centuries. The patio and spiral staircase with columns and Gothic capitols are from the same period. The building was acquired by Charles of Castellarnau during the XVIII century and important changes to the façade and interior distribution were made.

The noble floor has rooms with furniture from the XVIII and XIX centuries. The most emblematic area is the ballroom, with roof paintings depicting mythological themes done by Provençal painter Josep Bernat Flaugier at the end of the XVIII century.

An old kitchen has been restored on the ground floor. There is also a permanent sample of the Molas i Agramunt collection, a heterogenic set of archaeological and ethnographic pieces that cover a wide chronological period; the Quintana inheritance, where we can see a model of the first aeroplane to fly over the city in 1913. The building houses the Historic Heritage Council of the Tarragona City Council and the administrative offices of the Tarragona History Museum.



01 Courtyard and stairs (14th-15th century). **02** Temporary exhibition area. **03** Exhibition of legacies. **04** Kitchen.

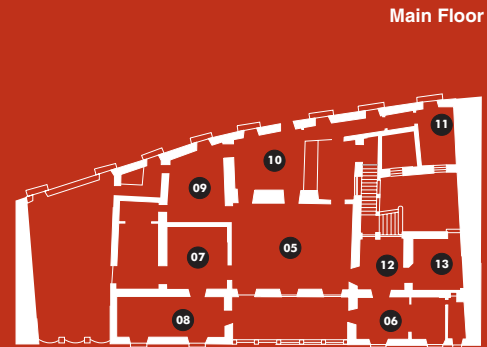

05 Room with ceiling decoration of mythological motifs (late 18th century). **06** Blue Bedroom. Elizabethan style in blue and gold. **07** Elizabeth II Bedroom with Louis XV furniture. **08** Yellow Room. Imperial furniture and monumental oriental ironwork from the 18th century. **09** Billiard Room. 18th and 19th century furniture. **10** Dining Room. 18th century furniture and 19th century fireplace. **11** Library-Study. Romantic period shelves. 19th century. **12** Hall. 17th and 18th century furniture. **13** Music Room.